

**Disclaimer for use of the Property Ownership Maps**  
 This Property Ownership Map and Data is created for ad valorem tax purposes on an annual basis by the Crook County Assessor's Office. The user of this data agrees not to reproduce these documents for resale purposes. Any user accepts the map and data "as is" and "with all faults." Any user of this data agrees to hold Crook County harmless from any liability arising from its use. This document does not constitute legal ownership or survey of the real property. The user should research the latest ownership of record in the Crook County Clerk's Office.

# Crook County Wyoming T54N R65W Sec 12 Q4 Ownership 1" = 200'

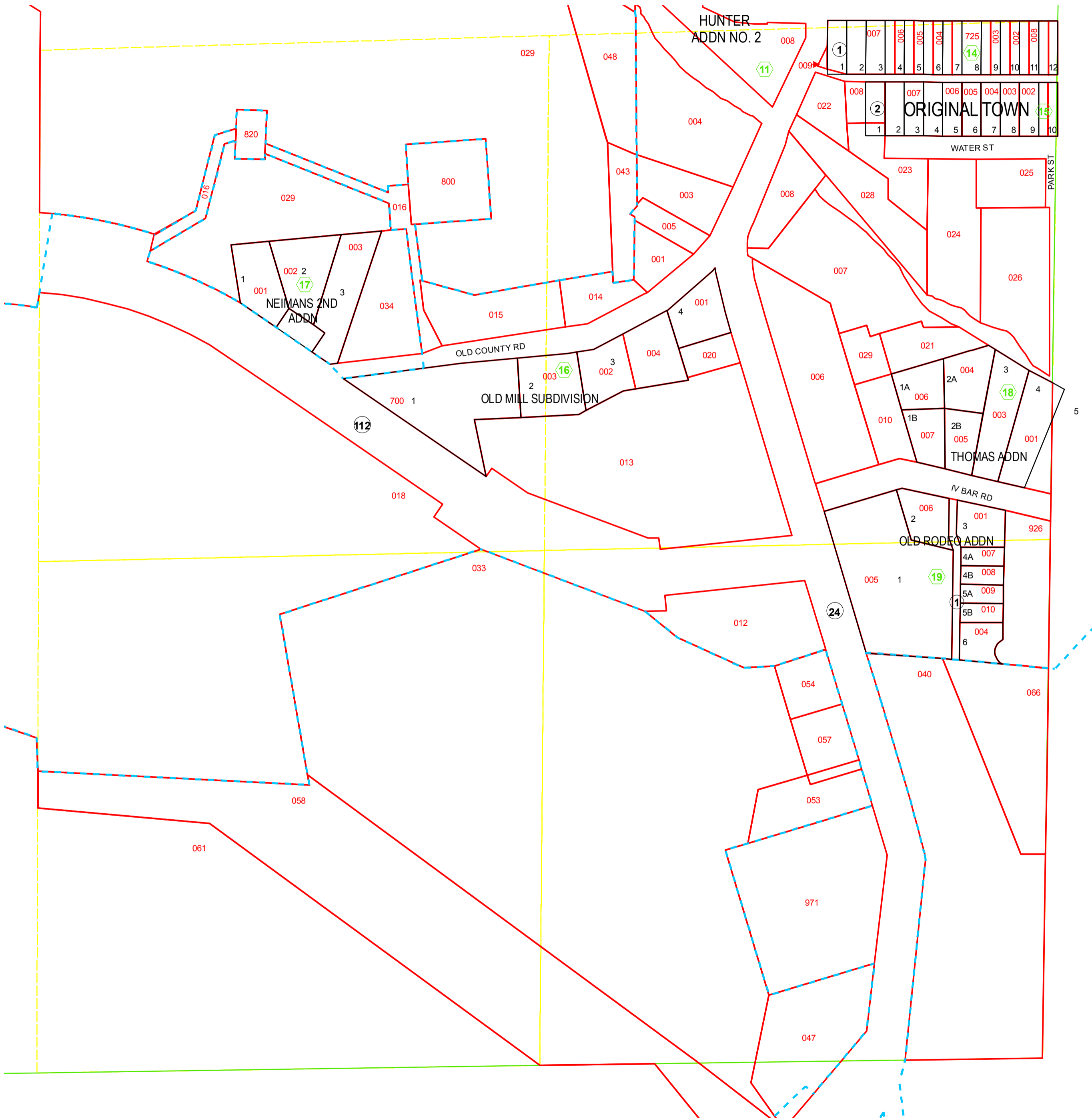

NUMBER	ARB BLK	TAXPAYER/NAME	PIDN
001	00	VITTO LORI RAE	5465 12 4 00 001.95
003	00	VITTO LORI RAE	5465 12 4 00 003.95
004	00	BOHL ECHO L	5465 12 4 00 004.95
005	00	VITTO DON J	5465 12 4 00 005.95
006	00	TOWER VALLEY AG SUPPLY LLC	5465 12 4 00 006.95
007	00	GAINES ELIZABETH M	5465 12 4 00 007.95
008	00	MCAMIS WILLIS DEE LIVING TRUST	
		MCAMIS WILLIS DEE TRUSTEE	5465 12 4 00 008.95
009	00	CHESHIER GLEN E & MARY KAY	5465 12 4 00 009.95
010	00	NEIMAN WILLIAM M & TONI F	5465 12 4 00 010.95
012	00	BALLOU WAYNE R & LEAH L & CODY	5465 12 4 00 012.95
013	00	BUSH LAND DEVELOPMENT CO	
		DBA SCREAMING EAGLE CAMP	5465 12 4 00 013.95
014	00	RYERSON STEPHEN & ANNETTE	5465 12 4 00 014.95
015	00	DAKNIS WALTER	5465 12 4 00 015.95
016	00	BUSH LAND DEVELOPMENT CO	5465 12 4 00 016.95
018	00	NEIMAN SAWMILLS INC	5465 12 3 00 018.00
020	00	BUSH RICHARD DEAN REV TRUST 1/2 & BUSH BOBBIE LOU REV TRUST 1/2	5465 12 4 00 020.95
021	00	BUSH VICTORIA	5465 12 4 00 021.95
022	00	HENDRICKS JIMMIE	5465 12 4 00 022.95
023	00	PROCTOR DONALD WILLIAM LIVING TRUST	
		PROCTOR DONALD WILLIAM TRUSTEE	5465 12 4 00 023.95
024	00	GILLAM WILLARD C & MICHELLE	5465 12 4 00 024.95
025	00	GANTZ RANDY E & BARBARA J	5465 12 4 00 025.95
026	00	MOORE JOY BELL	
		MOORE TIFFANY LA TOYA	5465 12 4 00 026.95
028	00	MCAMIS MELISSA LIVING TRUST	
		MCAMIS MELISSA ANN TRUSTEE	5465 12 4 00 028.95
029	00	BUSH LAND DEVELOPMENT CO	5465 01 3 00 029.00
029	00	ODELL VIVIAN ANN	5465 12 4 00 029.95
033	00	BALLOU WAYNE & LEAH	5465 12 4 00 033.00
034	00	BRIMMER EMMA (BEARS)	
		ATTN VELDA BRIMMER DEWS	5465 12 4 00 034.00
040	00	BEARLODGE FOREST PRODUCTS INC	
		ATTN DANIEL NEIMAN	5465 12 4 00 040.00
043	00	VITTO LORI RAE	5465 12 4 00 043.00
047	00	EATON JOYCE M	5465 12 4 00 047.00
048	00	BOHL ECHO L	5465 12 4 00 048.00
053	00	THOLE GARY L & CHRISTINE M	5465 12 4 00 053.00
054	00	OLSON RJ OF WYOMING LLC	5465 12 4 00 054.00
057	00	1517 APARTMENT LLC	5465 12 4 00 057.00
058	00	JH RANCH LLC	5465 12 4 00 058.00
061	00	JH RANCH LLC	5465 10 4 00 061.00
066	00	BLACKTAIL LUMBER INC	5465 12 4 00 066.00
800	00	TOWN OF HULETT	5465 12 4 00 800.95
820	00	TOWN OF HULETT	5465 12 4 00 820.95
926	00	HULETT COMMUNITY HOUSING AUTHORITY	5465 12 4 00 926.95
971	00	WYOMING STATE HIGHWAY DEPT	5465 12 4 00 971.95
		<b>HUNTER ADDITION NO. 2</b>	
008	11	SCHMID DEVELOPMENT CO LLC	
		DBA HULETT MOTEL & CAFE	5465 12 1 11 008.00
		<b>NEIMANS 2<sup>ND</sup> ADDITION</b>	
001	17	TYSVER ALBERT & TONYA	5465 12 4 17 001.00
002	17	FLOREY LAURAL	5465 12 4 17 002.00
003	17	BEARS SAMSON & DEB	5465 12 4 17 003.00
		<b>OLD MILL SUBDIVISION</b>	
001	16	NEIMAN JAMES S & SALLY ANN	5465 12 4 16 001.00
002	16	DENT FREIDA WILMA	5465 12 4 16 002.55
003	16	BEARS MICHAEL & MELISSA	5465 12 4 16 003.00
004	16	GEIB BRADLEY C & ANITA M	5465 12 4 16 004.55
700	16	CROOK COUNTY	5465 12 4 16 700.00
		<b>OLD RODEO ADDITION</b>	
001	19	NEIMAN MGMT & DEVELOPMENT CO	5465 12 4 19 001.00
004	19	NEIMAN MGMT & DEVELOPMENT CO	5465 12 4 19 004.00
005	19	NEIMAN MGMT & DEVELOPMENT CO	5465 12 4 19 005.00
006	19	NEIMAN MGMT & DEVELOPMENT CO	5465 12 4 19 006.00
007	19	NEIMAN MGMT & DEVELOPMENT CO	5465 12 4 19 007.00
008	19	WAUGH DUSTIN W & LESLIE A	5465 12 4 19 008.00
009	19	NEIMAN MGMT & DEVELOPMENT CO	5465 12 4 19 009.00
010	19	NEIMAN MGMT & DEVELOPMENT CO	5465 12 4 19 010.00
		<b>ORIGINAL TOWN</b>	
002	14	PARNELL DEENA L & ROSS W	5465 12 4 14 002.00
002	15	KNAPP CHRISTI LYNN MAURER	5465 12 4 15 002.00
003	14	RECEL ERGUN THOMAS	5465 12 4 14 003.00
003	15	GANTZ RANDY & BARBARA	5465 12 4 15 003.00
004	14	WILSON WAYNE R & SUSAN M	5465 12 4 14 004.00
****		<b>CONTINUED ON BACK OF PAGE</b>	****