

Disclaimer for use of the Property Ownership Maps
 This Property Ownership Map and Data is created for ad valorem tax purposes on an annual basis by the Crook County Assessor's Office. The user of this data agrees not to reproduce these documents for resale purposes. Any user accepts the map and data "as is" and "with all faults." Any user of this data agrees to hold Crook County harmless from any liability arising from its use. This document does not constitute legal ownership or survey of the real property. The user should research the latest ownership of record in the Crook County Clerk's Office.

Crook County Wyoming T54N R64W Sec 7 Q2 Ownership 1" = 200'

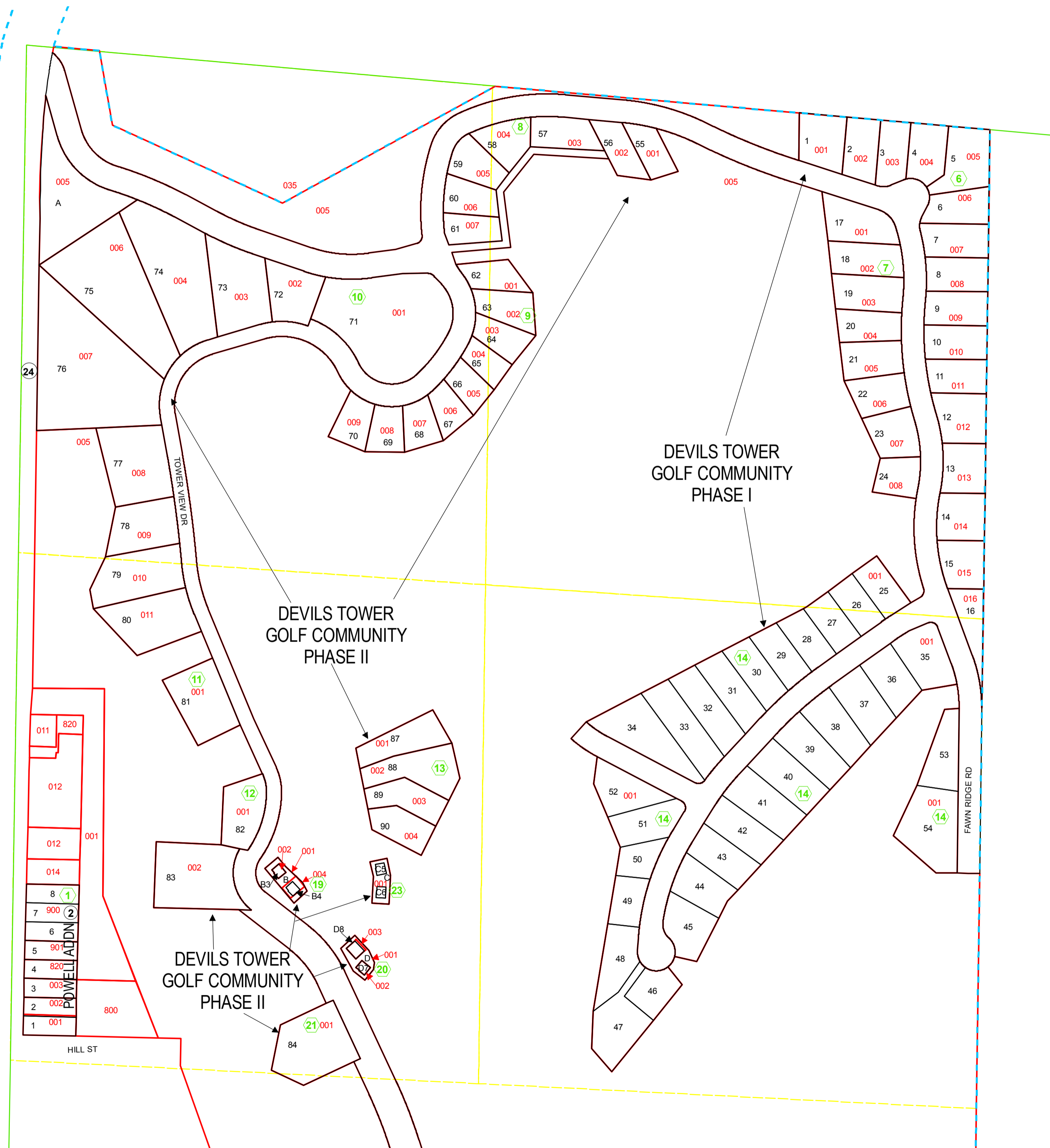

NUMBER	ARB BLK	TAXPAYER/NAME	PIDN
001	00	NEIMANS 77 RANCHES INC	5464 07 2 00 001.95
005	00	DEVILS TOWER GOLF & COUNTRY CLUB	5464 07 2 00 005.95
011	00	PROCTOR JAY D & KIMBERLY A	5464 07 2 00 011.95
012	00	DEVILS TOWER INN LLC	5464 07 2 00 012.95
014	00	CHESHIER GLEN & MARY ET AL	5464 07 2 00 014.95
035	00	DEVILS TOWER GOLF & COUNTRY CLUB INC	5464 06 3 00 035.00
800	00	TOWN OF HULETT	5464 07 2 00 800.95
820	00	TOWN OF HULETT	5464 07 2 00 820.95
DEVILS TOWER GOLF COMMUNITY PHASE I			
001	06	DEVILS TOWER GOLF & COUNTRY CLUB INC	5464 07 2 06 001.00
001	07	DEVILS TOWER GOLF & COUNTRY CLUB INC	5464 07 2 07 001.00
001	14	DEVILS TOWER GOLF & COUNTRY CLUB INC	5464 07 2 14 001.00
002	06	DEVILS TOWER GOLF & COUNTRY CLUB INC	5464 07 2 06 002.00
002	07	DEVILS TOWER GOLF & COUNTRY CLUB INC	5464 07 2 07 002.00
003	06	DEVILS TOWER GOLF & COUNTRY CLUB INC	5464 07 2 06 003.00
003	07	DEVILS TOWER GOLF & COUNTRY CLUB INC	5464 07 2 07 003.00
004	06	DEVILS TOWER GOLF & COUNTRY CLUB INC	5464 07 2 06 004.00
004	07	DEVILS TOWER GOLF & COUNTRY CLUB INC	5464 07 2 07 004.00
005	06	DEVILS TOWER GOLF & COUNTRY CLUB INC	5464 07 2 06 005.00
005	07	DEVILS TOWER GOLF & COUNTRY CLUB INC	5464 07 2 07 005.00
006	06	DEVILS TOWER GOLF & COUNTRY CLUB INC	5464 07 2 06 006.00
006	07	DEVILS TOWER GOLF & COUNTRY CLUB INC	5464 07 2 07 006.00
007	06	DEVILS TOWER GOLF & COUNTRY CLUB INC	5464 07 2 06 007.00
007	07	DEVILS TOWER GOLF & COUNTRY CLUB INC	5464 07 2 07 007.00
008	06	DEVILS TOWER GOLF & COUNTRY CLUB INC	5464 07 2 06 008.00
008	07	DEVILS TOWER GOLF & COUNTRY CLUB INC	5464 07 2 07 008.00
009	06	DEVILS TOWER GOLF & COUNTRY CLUB INC	5464 07 2 06 009.00
010	06	DEVILS TOWER GOLF & COUNTRY CLUB INC	5464 07 2 06 010.00
011	06	DEVILS TOWER GOLF & COUNTRY CLUB INC	5464 07 2 06 011.00
012	06	DEVILS TOWER GOLF & COUNTRY CLUB INC	5464 07 2 06 012.00
013	06	DEVILS TOWER GOLF & COUNTRY CLUB INC	5464 07 2 06 013.00
014	06	DEVILS TOWER GOLF & COUNTRY CLUB INC	5464 07 2 06 014.00
015	06	DEVILS TOWER GOLF & COUNTRY CLUB INC	5464 07 2 06 015.00
016	06	DEVILS TOWER GOLF & COUNTRY CLUB INC	5464 07 2 06 016.00
DEVILS TOWER GOLF COMMUNITY PHASE II			
001	08	PHELPS, JOHN & CATHERINE FAMILY TRUST JOHN H & CATHERINE A PHELPS, TRUSTEES	5464 07 2 08 001.00
001	09	EAST LAND DEVELOPMENT LLC	5464 07 2 09 001.00
001	10	DEVILS TOWER GOLF & COUNTRY CLUB INC	5464 07 2 10 001.00
001	11	CLAUSEN WESLEY W	5464 07 2 11 001.00
001	12	KING BRIAN T & JACKIE R	5464 07 2 12 001.00
001	13	RAUCH CLAUDE L & SANDRA K	5464 07 2 13 001.00
001	19	DEVILS TOWER GOLF & COUNTRY CLUB INC	5464 07 2 19 001.00
001	20	DEVILS TOWER GOLF & COUNTRY CLUB INC	5464 07 2 20 001.00
001	21	SASSER KATHY L REVOCABLE TRUST	5464 07 2 21 001.00
001	22	DEVILS TOWER GOLF & COUNTRY CLUB INC ATTN: DAVIS JERRY & MARCIA	5464 07 2 22 001.00

**** CONTINUED ON BACK OF PAGE ****